

PEUGEOT 106 AND SAXO RHS ENGINE MOUNTING

Part No. PSA300M
PSA302MX

Date
01/08/08

Sheet No.
01

FITTING INSTRUCTIONS

Originator
JW

GENERAL

Before removing the standard (OE) Engine mount ensure the engine is supported on a jack or hoist.

Remove the OE mount and bracket from the engine.

The mounting hole in the bracket needs to be drilled through 12mm



Drill this hole through 12mm

The **VIBRA-TECHNICS** mount can now be fitted to the body, but leave the two 8mm screws finger tight.

Refit the bracket to the engine and assemble the 12mm bolt and spacer plus washers and rebound ring in the order shown.

Fully tighten the two 8mm screws to the body. Fully tighten the 12mm nut and bolt through the mount(suggest 85Nm torque)

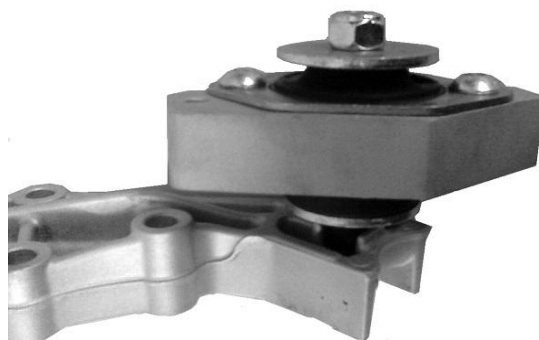

Run the car for a about 5 miles. If the vibration feels excessive slacken the two 8mm screws and the same screws on the gearbox side mount and physically rock the engine back and forward by hand then retighten all screws. This should allow the engine to centralise in a neutral load position.